

SEGHE TCT SILENZIATE PER IL TAGLIO DI METALLI NON FERROSI
LOW NOISE TCT SAW BLADES FOR NON-FERROUS METALS
KREISSÄGEBLÄTTER ZUM SCHNEIDEN VON NE-METALLEN – GERÄUSCHARM

NEGATIVE

Adatte per il taglio di profilati in alluminio e/o metalli non ferrosi.

Suitable for cutting aluminium and non-ferrous profiles.

Geeignet für Alu-Profile und NE-Metalle.

Ø D	B	b	Ø d	PH	Z	Type
[mm]	[mm]	[mm]	[mm]			
250	3,4	2,6	30/32	2/11/63	60	TCG
250	3,4	2,6	30/32	2/11/63	80	TCG
300	3,4	2,6	30/32	2/11/63	72	TCG
300	3,4	2,6	30/32	2/11/63	96	TCG
350	3,4	2,6	30/32	2/11/63	84	TCG
350	3,4	2,6	30/32	2/11/63	108	TCG
400	4,0	3,2	30/32	2/11/63	96	TCG
400	4,0	3,2	30/32	2/11/63	108	TCG
400	4,0	3,2	30/32	2/11/63	120	TCG
450	4,0	3,2	30/32	2/11/63	108	TCG
450	4,0	3,2	30/32	2/11/63	128	TCG
500	4,6	3,6	30/32	2/11/63	120	TCG
500	4,6	3,6	30/32	2/11/63	140	TCG
550	4,6	3,6	30/32	2/11/63	140	TCG
550	4,6	3,6	30/32	2/11/63	172	TCG



SILENZIATE / LOW NOISE / GERÄUSCHARM:

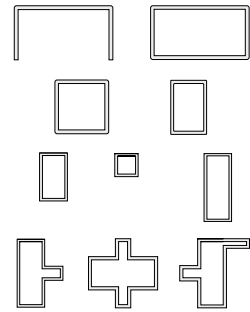
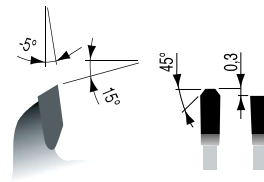

Caratteristiche tecniche / Technical features / Technische Merkmale

Angoli / Angles / Winkel: -5° / 15°

Altezza placchetta / Tip dimension / Bestückungshöhe: 8 mm

Metallo duro / Carbide Grade / Hartmetall: K10

POSITIVE

Indicate per il taglio di sezioni piene in alluminio e/o altri metalli non ferrosi.

Suitable for cutting full sections in aluminium or non-ferrous solid materials.

Geeignet für NE-Metalle, Vollmaterial.

Ø D	B	b	Ø d	PH	Z	Type
[mm]	[mm]	[mm]	[mm]			
250	3,4	2,6	30/32	2/11/63	60	TCG
250	3,4	2,6	30/32	2/11/63	80	TCG
300	3,4	2,6	30/32	2/11/63	72	TCG
300	3,4	2,6	30/32	2/11/63	96	TCG
350	3,4	2,6	30/32	2/11/63	84	TCG
350	3,4	2,6	30/32	2/11/63	108	TCG
400	4,0	3,2	30/32	2/11/63	96	TCG
400	4,0	3,2	30/32	2/11/63	108	TCG
400	4,0	3,2	30/32	2/11/63	120	TCG
450	4,0	3,2	30/32	2/11/63	108	TCG
450	4,0	3,2	30/32	2/11/63	128	TCG
500	4,6	3,6	30/32	2/11/63	120	TCG
500	4,6	3,6	30/32	2/11/63	140	TCG
550	4,6	3,6	30/32	2/11/63	120	TCG
550	4,6	3,6	30/32	2/11/63	140	TCG

SILENZIATE / LOW NOISE / GERÄUSCHARM:

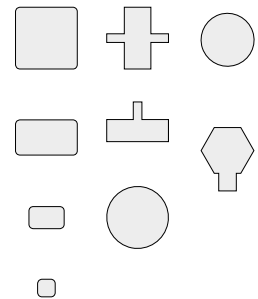
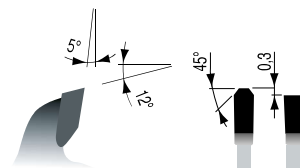

Caratteristiche tecniche / Technical features / Technische Merkmale

Angoli / Angles / Winkel: 5° / 12°

Altezza placchetta / Tip dimension / Bestückungshöhe: 8 mm

Metallo duro / Carbide Grade / Hartmetall: K10

**LAME TCT CROMATE SILENZIATE
PER IL TAGLIO DI METALLI NON FERROSI
LOW NOISE CHROME-PLATED TCT
SAW BLADES FOR NON-FERROUS METALS
CHROMATIERTE KREISSÄGEBLÄTTER ZUM
SCHNEIDEN VON NE-METALLEN – GERÄUSCHARM**

NEGATIVE

Adatte per il taglio di profilati in alluminio e/o metalli non ferrosi su macchine troncatrici con bloccaggio manuale o meccanico del pezzo. Si consiglia l'uso con la lama sopra al pezzo da tagliare.

Suitable for cutting aluminium and non-ferrous profiles on miter saws with manual or mechanical clamping of the piece. Use with the saw blade over the workpiece to be cut is recommended.

HW-Kreissägeblätter mit negativem Spanwinkel, geeignet für dünnwandige Profile aus Aluminium und Kunststoff.



Ø D	B	b	Ø d	PH	Z	Type
[mm]	[mm]	[mm]	[mm]			
250	3,5	3,0	30	2/9/46,4 + 2/10/60	80	TCG
300	3,5	3,0	30	2/9/46,4 + 2/10/60	96	TCG
350	3,5	3,0	30	2/9/46,4 + 2/10/60	108	TCG

SILENZIATE /
LOW NOISE /
GERÄUSCHARM:

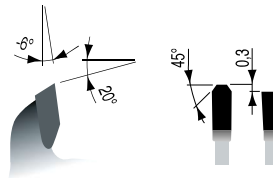
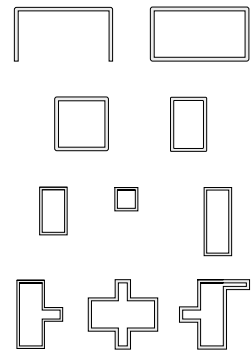

Caratteristiche tecniche / Technical features / Technische Merkmale

Angoli / Angles / Winkel: -5° / 20°

Altezza placchetta / Tip dimension / Bestückungshöhe: 8 mm

Metallo duro / Carbide Grade / Hartmetall: K10

POSITIVE

Adatte per il taglio di sezioni piene in alluminio e/o altri metalli non ferrosi su macchine troncatrici singole o doppie con bloccaggio meccanico del pezzo.

Suitable for cutting full sections in aluminium or non-ferrous solid materials on single or double miter saws with mechanical clamping of the piece.

HW-Kreissägeblätter mit positivem Spanwinkel, geeignet für NE-Metalle und Kunststoffe, für Profile und Vollmaterial.

Ø D	B	b	Ø d	PH	Z	Type
[mm]	[mm]	[mm]	[mm]			
250	3,5	3,0	30	2/9/46,4 + 2/10/60	80	TCG
300	3,5	3,0	30	2/9/46,4 + 2/10/60	96	TCG
350	3,5	3,0	30	2/9/46,4 + 2/10/60	108	TCG

SILENZIATE /
LOW NOISE /
GERÄUSCHARM:

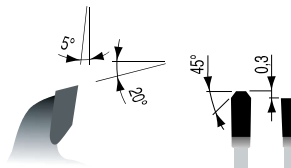
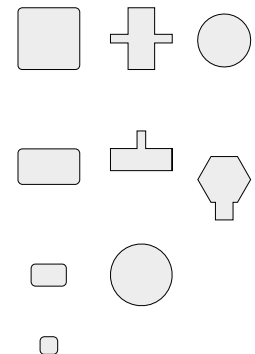

Caratteristiche tecniche / Technical features / Technische Merkmale

Angoli / Angles / Winkel: 5° / 20°

Altezza placchetta / Tip dimension / Bestückungshöhe: 8 mm

Metallo duro / Carbide Grade / Hartmetall: K10

**LAME TCT RIVESTITE PVD CON INTAGLI "LOW NOISE"
PER IL TAGLIO DI METALLI NON FERROSI
PVD COATED TCT SAW BLADES WITH
LOW NOISE SLOTS FOR NON-FERROUS METALS
PVD-BESCHICHTETE KREISSÄGEBLÄTTER ZUM
SCHNEIDEN VON NE-METALLEN – GERÄUSCHARM**

NEGATIVE

Lame circolari rivestite PVD. Adatte per il taglio di profilati in alluminio e/o metalli non ferrosi.

Pvd coated circular saw blades. Suitable for cutting aluminium and non-ferrous profiles.

Sägeblätter mit PVD-Beschichtung. Geeignet für Alu-Profilen und NE-Metalle.



Ø D	B	b	Ø d	PH	Z	Type
[mm]	[mm]	[mm]	[mm]			
250	3,4	2,6	30/32	2/11/63	60	TCG
250	3,4	2,6	30/32	2/11/63	80	TCG
300	3,4	2,6	30/32	2/11/63	72	TCG
300	3,4	2,6	30/32	2/11/63	96	TCG
350	3,4	2,6	30/32	2/11/63	84	TCG
350	3,4	2,6	30/32	2/11/63	108	TCG
400	4,0	3,2	30/32	2/11/63	96	TCG
400	4,0	3,2	30/32	2/11/63	108	TCG
400	4,0	3,2	30/32	2/11/63	120	TCG
450	4,0	3,2	30/32	2/11/63	108	TCG
450	4,0	3,2	30/32	2/11/63	128	TCG
500	4,6	3,6	30/32	2/11/63	120	TCG
500	4,6	3,6	30/32	2/11/63	140	TCG
550	4,6	3,6	30/32	2/11/63	140	TCG
550	4,6	3,6	30/32	2/11/63	172	TCG

SILENZIATE /
LOW NOISE /
GERÄUSCHARM:

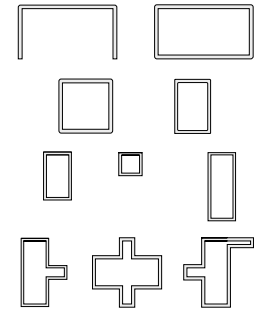
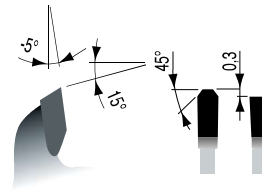

Caratteristiche tecniche / Technical features / Technische Merkmale

Angoli / Angles / Winkel: -5° / 15°

Altezza placchetta / Tip dimension / Bestückungshöhe: 8 mm

Metallo duro / Carbide Grade / Hartmetall: K10

POSITIVE

Indicate per il taglio di sezioni piene in alluminio e/o altri metalli non ferrosi.

Suitable for cutting full sections in aluminium or non-ferrous solid materials.

Geeignet für NE-Metalle, Vollmaterial.

Ø D	B	b	Ø d	PH	Z	Type
[mm]	[mm]	[mm]	[mm]			
250	3,4	2,6	30/32	2/11/63	60	TCG
250	3,4	2,6	30/32	2/11/63	80	TCG
300	3,4	2,6	30/32	2/11/63	72	TCG
300	3,4	2,6	30/32	2/11/63	96	TCG
350	3,4	2,6	30/32	2/11/63	84	TCG
350	3,4	2,6	30/32	2/11/63	108	TCG
400	4,0	3,2	30/32	2/11/63	96	TCG
400	4,0	3,2	30/32	2/11/63	108	TCG
400	4,0	3,2	30/32	2/11/63	120	TCG
450	4,0	3,2	30/32	2/11/63	108	TCG
450	4,0	3,2	30/32	2/11/63	128	TCG
500	4,6	3,6	30/32	2/11/63	120	TCG
500	4,6	3,6	30/32	2/11/63	140	TCG
550	4,6	3,6	30/32	2/11/63	120	TCG
550	4,6	3,6	30/32	2/11/63	140	TCG

SILENZIATE /
LOW NOISE /
GERÄUSCHARM:

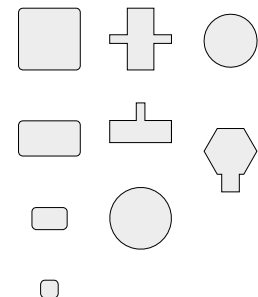
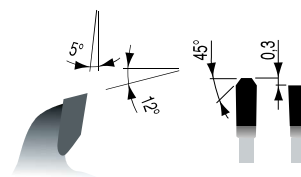

Caratteristiche tecniche / Technical features / Technische Merkmale

Angoli / Angles / Winkel: 5° / 12°

Altezza placchetta / Tip dimension / Bestückungshöhe: 8 mm

Metallo duro / Carbide Grade / Hartmetall: K10